

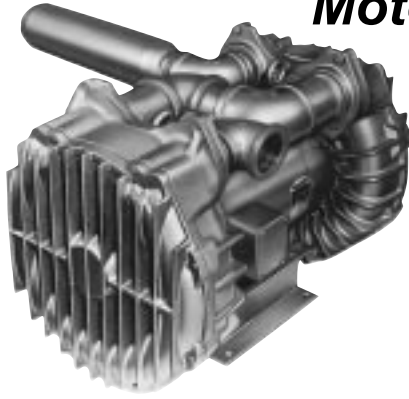

Oilless Regenerative Blowers, Motor Mounted



REGENAIR® R9S Series

MODEL R9S3300M

8 PSI MAXIMUM PRESSURE, 660 cfm OPEN FLOW (60 HZ)
150" H₂O / 11" Hg MAXIMUM VACUUM

PRODUCT FEATURES

- Made in the U.S.A.
- Oilless operation
- UL and CSA approved motor with permanently sealed ball bearings. Class F insulation
- Cast iron blower housing and cover. Cast aluminum impeller.
- CE compliant model with BSP pipe ports available
- External muffler for additional silencing AJ121H (3" M/FPT)
- Smaller and lower cost than 2 blowers

RECOMMENDED ACCESSORIES

- Pressure gauge AE133F
- Inlet filter (pressure) AJ126M (5" MPT)
- Vacuum gauge AE134
- Vacuum gauge for monitoring inlet filter restriction AJ497
- Pressure/Vacuum relief valve AG258F (2 1/2" M/FPT)
- Silencer for vacuum relief valve AJ121G
- In line filter (vacuum) AJ151M (5" M/FPT)
- Two moisture separators, RMS400 (for vacuum line) mounted in parallel in customer provided plumbing

(mm) (Inches)

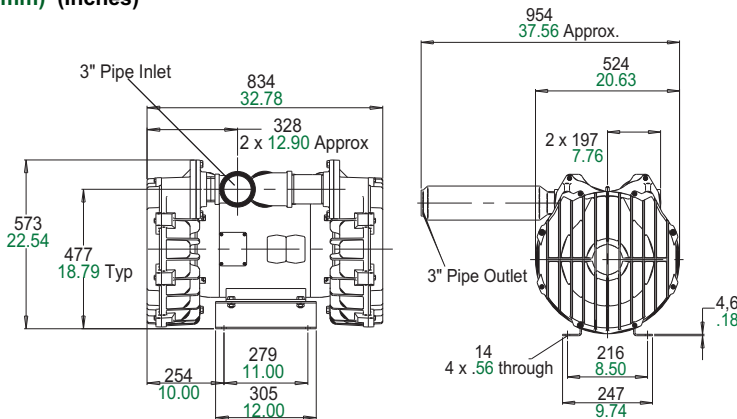

Product Specifications

Recommended NEMA starter size for motor - 3/3

Specifications subject to change without notice

Model Number	Motor Specs	Full Load Amps	Starting Amps	HP	KW	RPM	Max Vac		Max Pressure		Max Flow		Net Wt.	
							"Hg / "H ₂ O	mbar	PSIG	mbar	cfm	m ³ /h	lbs.	kg
R9S3300M	230/460-60-3	98/49	640/320	30	22,3	3500	11 / 150	374	8	552	660	1121	606	275
	190-220/380-440-50-3	82-47/41-39	616/308	19	14,3	2850	10.5 / 143	357	7.5	518	542	921		

Note: Unit must be mounted with shaft horizontal

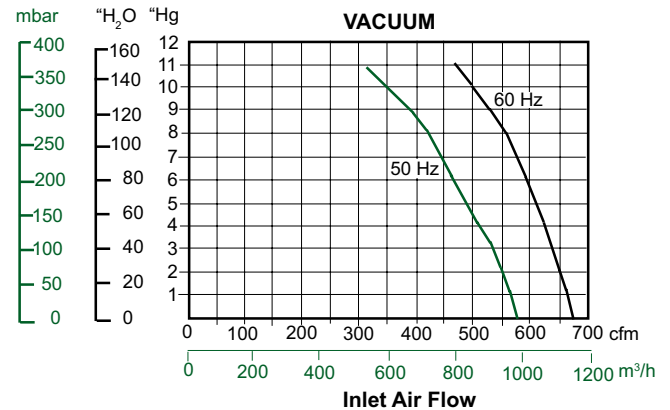
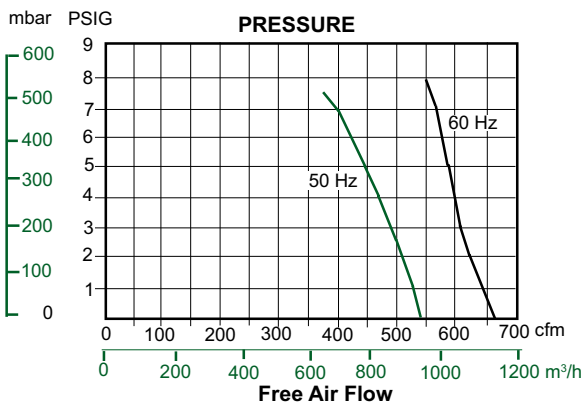

Pressure vs Air Temp Rise Over Ambient (°F)

Pressure vs. K Watts Input

PSI	60 Hz	50 Hz
0	36	25
1	53	41
2	70	58
3	86	74
4	101	92
5	119	115
6	140	139
7	162	168
8	184	-

PSI	60 Hz	50 Hz
0	9.2	5.5
1	11.9	7.7
2	14.3	9.8
3	17.1	11.9
4	19.5	14
5	22.1	16.1
6	25	18.6
7	27.9	20.9
8	30.5	-

Vacuum vs Air Temp Rise Over Ambient (°F)

Vacuum vs K Watts Input

In. H ₂ O	60 Hz	50 Hz
0	37	28
20	47	36
40	56	48
60	68	62
80	84	82
100	108	106
120	145	143
140	174	160
150	192	180

In. H ₂ O	60 Hz	50 Hz
0	8.9	5.5
20	10.32	6.5
40	12.0	7.85
60	13.45	9.17
80	14.8	10.4
100	16.31	11.88
120	18.02	13.35
140	19.66	-
150	20.46	-